

TYPE

A2

604 pi² / sqft



- 1** CUISINE / KITCHEN
10'-9" x 9'-0"
- 2** SALON / LIVING
10'-9" x 10'-8"
- 3** SALLE À MANGER / DINING
10'-9" x 10'-8"
- 4** SALLE DE BAIN / BATHROOM
10'-6" x 4'-8"
- 5** CHAMBRE 1 / BEDROOM 1
10'-6" x 9'-9"
- B** BALCON / BALCONY
Les dimensions et l'emplacement
varient selon l'étage
*Dimensions and location vary
depending on the floor*

UNITÉS / UNITS

107
207
307
407
507

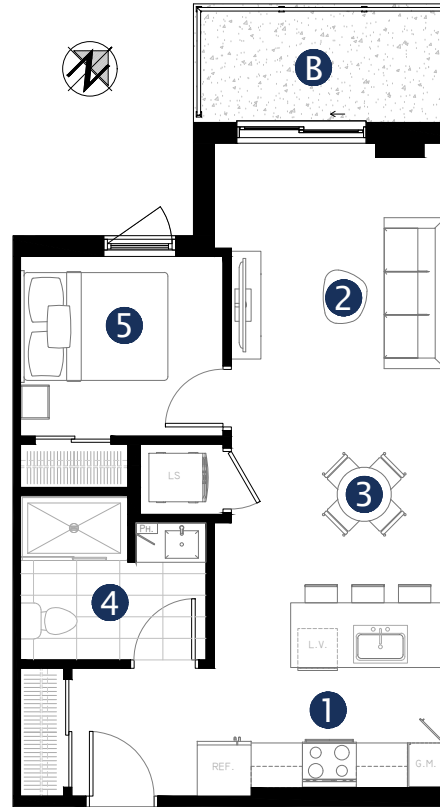

ENTRÉE
ENTRY

LIVEO
BOIS-FRANC

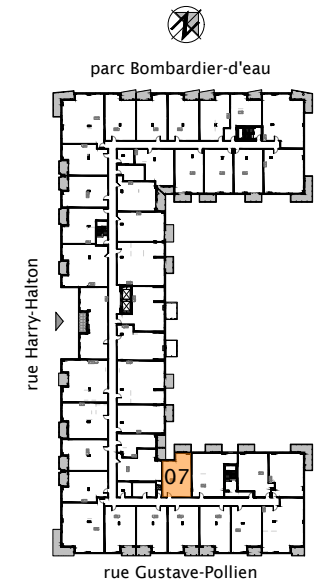

CONDOS LOCATIFS
RENTAL CONDOS
liveoboisfranc.com

Mobilier à titre indicatif seulement, non-inclus. Électroménagers inclus. Plans préliminaires sujets à changements. La superficie brute des logements n'inclut pas celle des balcons et/ou terrasses. La superficie et les dimensions des plans de vente sont approximatives et peuvent varier.

Furnishings shown are for illustrative purposes only and are not included. Appliances are included. Preliminary plans are subject to modification. The unit area does not include balconies or terraces. All areas and dimensions are approximate and may vary.